



## Food Grade Tri Clamp Butterfly Valve With Precision CNC Milling Machined Body

Our Product Introduction

for more products please visit us on [watercontrol-valve.com](http://watercontrol-valve.com)

### Basic Information

- Place of Origin: China
- Brand Name: OEM
- Certification: CE,3A, FDA
- Model Number: CX-SBTV-002
- Minimum Order Quantity: 1
- Price: Negotiable
- Packaging Details: Plywood Cases
- Delivery Time: 15-60 Days
- Payment Terms: L/C, T/T
- Supply Ability: Based On Order



### Product Specification

- Operation: SS Gripper Handle, Pull Lever
- Diameter: DN15 - DN300, 1/2" - 12"
- Working Pressure: 0~10 Bar
- Connection Ends: Butt Weld, Clamp, Union, Thread,
- Connection Standard: DIN, 3A, SMS, ISO, IDF, etc..
- Name: Tri Clamp Butterfly Valve
- Highlight: **stainless steel butterfly valve**



### More Images



## Product Description

### Food Grade SS 304 316L Tri Clamp Butterfly Valve With Ss Gripper Handle

#### Forming Machine Process

1. CNC Lathe Processing
2. High precision CNC machining center processing
3. General lathe processing
4. The machine punch the product parts
5. Cold Forming Molding
6. Welding Assembly

Work principle:

This kind of valve are handled by manual. CX FLUID offers three types handle, such as stainless steel multi-position handle, plastic multi-position handle, and pulling handle. Multi-position handle regulates the valve by 13 seats achieving control of medium flow purpose. Pulling handle regulates the valve through four multi-function positioning, in its open or close four position, also achieves control of medium flow purpose.

This kind of valve also can be handled by a pneumatic actuator. Pneumatic actuator is to convert the axial movement of piston to be 90 degree rotation of valve shaft, so that the valve can be open or close to achieve the requirement of control and open /close for the pipeline system. They have three type of actuator: normally open (NO), normally closed (NC), air/air(A/A)

Specification:

Product name:	<b>Food Grade Sanitary SS 304 316L tri clamped Butterfly Valve with Ss Gripper Handle</b>
Valve Body:	SS 304. SS 316L material out from precision CNC milling machined.
Feature:	Body can be changeable. And low torque.
Standard:	BS. SMS. DIN 3A weld and male/male end. Clamp end.
Artwork:	Electro polished and PTFE coating can be Required.
Handle:	Different nylon re-force and stainless steel handle gripper, pull, Press type.
Operation:	From 2 Position-12 Position, Design for your width range and beautiful choice.
Size:	DN15-DN300&1/2"-12"
Design:	Remote-controlled operation by the driving gear or manual operation by the handle
Drive forms:	Normally closed, normally opened and opened & closed by two air flues separately.
Medium:	Beer, Food, beverage, dairy, pharmacy, chemical or any food processing industries

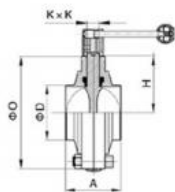

#### Welded Butterfly Valve

#### 3A/ISO/IDF/SMS

Size	O	D	KxK	A	H
19	78.0	19.0	8.0×8.0	50.0	39.0
25	78.0	25.4	8.0×8.0	50.0	39.0
32	80.0	31.8	8.0×8.0	50.0	40.0
38	80.0	38.1	8.0×8.0	50.0	40.0
45	95.0	45.0	8.0×8.0	50.0	47.5
51	100.0	50.8	8.0×8.0	50.0	50.0
57	110.0	57.0	8.0×8.0	50.0	55.0
63	117.0	63.5	10.0×10.0	55.0	58.5
76	129.0	76.2	10.0×10.0	60.0	64.5
89	140.0	89.0	10.0×10.0	62.0	70.0
102	160.0	101.6	10.0×10.0	65.0	80.0
108	160.0	108.0	10.0×10.0	65.0	80.0
133	190.0	133.0	12.0×12.0	74.0	95.0
159	225.0	159.0	12.0×12.0	80.0	112.5
219	285.0	219.0	14.0×14.0	85.0	142.5

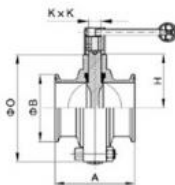

#### Clamped Butterfly Valve

#### 3A/ISO/IDF/SMS

Size	O	B	KxK	A	H
19	78.0	25.4	8.0×8.0	68.0	39.0
25	78.0	50.5	8.0×8.0	68.0	39.0
32	80.0	50.5	8.0×8.0	72.0	40.0
38	80.0	50.5	8.0×8.0	72.0	40.0
45	95.0	64.0	8.0×8.0	72.0	47.5
51	100.0	64.0	8.0×8.0	74.0	50.0
57	110.0	77.5	8.0×8.0	74.0	55.0
63	117.0	77.5	10.0×10.0	80.0	58.5
76	129.0	91.0	10.0×10.0	80.0	64.5
89	140.0	106.0	10.0×10.0	85.0	70.0
102	160.0	119.0	10.0×10.0	90.0	80.0
108	160.0	119.0	10.0×10.0	90.0	80.0
133	190.0	145.0	12.0×12.0	114.0	95.0
159	225.0	183.0	12.0×12.0	120.0	112.5
219	285.0	233.5	14.0×14.0	126.0	142.5

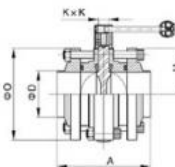

#### Three-Piece Butterfly Valve

#### 3A/ISO/IDF/SMS

Size	O	B	KxK	A	H
19	78.0	19.0	8.0×8.0	100.0	39.0
25	78.0	25.4	8.0×8.0	100.0	39.0
32	80.0	31.8	8.0×8.0	100.0	40.0
38	80.0	38.1	8.0×8.0	100.0	40.0
45	95.0	45.0	8.0×8.0	100.0	47.5
51	100.0	50.8	8.0×8.0	100.0	50.0
57	110.0	57.0	8.0×8.0	104.0	55.0
63	117.0	63.5	10.0×10.0	100.0	58.5
76	129.0	76.2	10.0×10.0	100.0	64.5
89	140.0	89.0	10.0×10.0	100.0	70.0
102	160.0	101.6	10.0×10.0	108.0	80.0
108	160.0	108.0	10.0×10.0	108.0	80.0
133	190.0	133.0	12.0×12.0	114.0	95.0
159	225.0	159.0	12.0×12.0	120.0	112.5
219	285.0	219.0	14.0×14.0	130.0	142.5

#### Handle selection

Two-position handle;  
three-position handle;  
four-position pull handle;  
multi-position plastic handle;  
multi-position stainless steel handle;

#### Connection

Clamped, welded and threaded etc.  
Packaging Details  
Bubble pack for each valve.  
Outside packing are carton

**RELATED PRODUCT**  
survive by quality, development by credit, and efficiency by management



Stainless Steel Manual Welding Butterfly Valve with Multi-Position Handle



Stainless Steel Sanitary 3A Clamping Butterfly Valves



Stainless Steel Ss304 Sanitary DIN Thread Butterfly Valve



Stainless Steel Sanitary three-presses Butterfly Valves



Dn50 Sanitary Manual Male Butterfly manual male butterfly Valves



Stainless Steel Sanitary Tri Clamp Butterfly Valves with pull handle



Stainless Steel Sanitary Flange Male Ends Butterfly Valve



Sanitary Manual Male Butterfly Valves



Stainless Steel Sanitary SMS Weld Butterfly Valves



Butterfly Valve with Control Head



Butterfly Valve with Pneumatic Actuator



Butterfly Valve with Sensor Position



**Beijing Silk Road Enterprise Management Services Co.,LTD**



17733330123



micleanmo@gmail.com



watercontrol-valve.com

18-2 JinFu East Rd. Ulks Village. Futian New district. Shenzhen. China.