



Stainless Steel Sanitary Butterfly Valve With Union Connection End

Our Product Introduction

for more products please visit us on watercontrol-valve.com

Basic Information

- Place of Origin: China
- Brand Name: OEM
- Certification: 3A, CE, ISO, ASME BPE
- Model Number: CX-3W-BV08
- Minimum Order Quantity: 1
- Price: Negotiable
- Packaging Details: Plywood Cases
- Delivery Time: 15-60 Days
- Payment Terms: L/C, T/T
- Supply Ability: Based On Order



Product Specification

- Material: Forged 304 Or 316L Stainless Steel
- Power: Pull Rod Manual Handle
- Size: 1" ~ 8", DN25 ~ DN200
- Hygienic Grade: Food Grade, Biotechnology And Pharmaceutical Grade
- Connection End: Unions
- Medium: Food, Dairy, Cosmetics, Pharmacy, Chemical, Beverage, Breweries
- Highlight: **stainless steel butterfly valve**



More Images



Product Description

Sanitary Stainless Steel Union End Butterfly Valve with Pull handle

Specifications:

Driving Mode:	Sanitary SS304 SS316L Stainless Steel Butterfly Valve with Union Connection
Connection End:	Unions
Size:	1" ~ 8", DN25 ~ DN200, all other sizes can be customized
Material:	SUS304, or SUS316L
Gasket:	Free choice among EPDM, PTF E, FPM or NBR
Working Pressure:	Low Pressure (Pn<1.6mpa)
Working Temperature:	-10°C ~ +95°C
Surface Process:	Matte or mirror Polishing 180#/240/320/400
Connection Standard:	ISO 2853, DIN 11851, DIN 11853-1, DIN 11864-1, BS 4825-4

Surface Treatment

We offer the following processes to choose:

1. Mechanical Polishing (MP) to improve brightness (gloss, matte)
2. Acid Cleaning for Anti-corrosion
3. Electrolysis Polish (EP) to improve surface smoothness
4. Custom Process: Bright Annealing treatment eliminate stresses to improve toughness

Raw Materials:

1. Valve body: Forged 304 or 316L stainless steel, high density, highly sanitary grade
2. Manual handle: Stainless steel handle with nylon sleeve or handle ball
3. Seal gasket: EPDM, high temperature resistant, anti-aging and anti-corrosion

Structures:

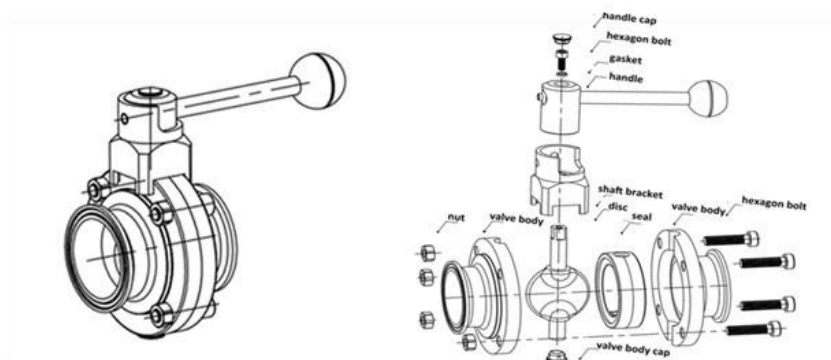

Highlights of Union Connection End:

1. Very scientific connection design with high sealing function
2. High mechanical property to withstand strong force
3. Fast connection and disassembly, saving time
4. Exteremely convenient for daily repair and maintainance

Union Connection End Dimension Standards:

1. ISO 2853: ISS / IDF Hygienic stainless steel couplings for food applications
2. DIN 11851: Unions screwed pipe fittings for food chemical and pharmaceutical industry
3. DIN 11853-1: Hygienic pipe screw connections, short type
4. DIN 11864-1: Aseptic screwed pipe connection for welding type union
5. BS 4825 PART 4: IDF / ISS Hygienic stainless steel thread couplings for food applications

Product Show:

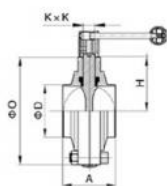

Welded Butterfly Valve

3A/ISO/IDF/SMS

Size	O	D	KxK	A	H
19	78.0	19.0	8.0×8.0	50.0	39.0
25	78.0	25.4	8.0×8.0	50.0	39.0
32	80.0	31.8	8.0×8.0	50.0	40.0
38	80.0	38.1	8.0×8.0	50.0	40.0
45	95.0	45.0	8.0×8.0	50.0	47.5
51	100.0	50.8	8.0×8.0	50.0	50.0
57	110.0	57.0	8.0×8.0	50.0	55.0
63	117.0	63.5	10.0×10.0	56.0	58.5
76	129.0	76.2	10.0×10.0	60.0	64.5
89	140.0	89.0	10.0×10.0	62.0	70.0
102	160.0	101.6	10.0×10.0	65.0	80.0
108	160.0	108.0	10.0×10.0	65.0	80.0
133	190.0	133.0	12.0×12.0	74.0	95.0
159	225.0	159.0	12.0×12.0	80.0	112.5
219	285.0	219.0	14.0×14.0	85.0	142.5

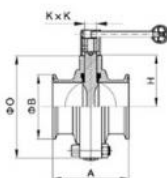

Clamped Butterfly Valve

3A/ISO/IDF/SMS

Size	O	B	KxK	A	H
19	78.0	25.4	8.0×8.0	63.0	39.0
25	78.0	50.5	8.0×8.0	68.0	39.0
32	80.0	50.5	8.0×8.0	72.0	40.0
38	80.0	50.5	8.0×8.0	72.0	40.0
45	95.0	64.0	8.0×8.0	72.0	47.5
51	100.0	64.0	8.0×8.0	74.0	50.0
57	110.0	77.5	8.0×8.0	74.0	55.0
63	117.0	77.5	10.0×10.0	80.0	58.5
76	129.0	91.0	10.0×10.0	80.0	64.5
89	140.0	106.0	10.0×10.0	85.0	70.0
102	160.0	119.0	10.0×10.0	90.0	80.0
108	160.0	119.0	10.0×10.0	90.0	80.0
133	190.0	145.0	12.0×12.0	114.0	95.0
159	225.0	183.0	12.0×12.0	120.0	112.5
219	285.0	233.5	14.0×14.0	126.0	142.5

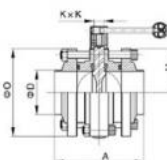

Three-Piece Butterfly Valve

3A/ISO/IDF/SMS

Size	O	B	KxK	A	H
19	78.0	19.0	8.0×8.0	100.0	39.0
25	78.0	25.4	8.0×8.0	100.0	39.0
32	80.0	31.8	8.0×8.0	100.0	40.0
38	80.0	38.1	8.0×8.0	100.0	40.0
45	95.0	45.0	8.0×8.0	100.0	47.5
51	100.0	50.8	8.0×8.0	100.0	50.0
57	110.0	57.0	8.0×8.0	104.0	55.0
63	117.0	63.5	10.0×10.0	100.0	58.5
76	129.0	76.2	10.0×10.0	100.0	64.5
89	140.0	89.0	10.0×10.0	100.0	70.0
102	160.0	101.6	10.0×10.0	108.0	80.0
108	160.0	108.0	10.0×10.0	108.0	80.0
133	190.0	133.0	12.0×12.0	114.0	95.0
159	225.0	159.0	12.0×12.0	120.0	112.5
219	285.0	219.0	14.0×14.0	130.0	142.5



Beijing Silk Road Enterprise Management Services Co.,LTD



17733330123



miclecleanmo@gmail.com



watercontrol-valve.com

18-2 JinFu East Rd. Ulks Village. Futian New district. Shenzhen. China.