



Light Weight Trunnion Ball Valve , Corrosion Resistant V Type Ball Valve

Our Product Introduction

Basic Information

- Place of Origin: China
- Brand Name: OEM
- Certification: API, ISO, CE, GOST, TS, BS1873, BS5351, API 6D, 600, 602, 609, ASME B16.34, API 6FA, API607 etc
- Model Number: 1/2"-20", CL150-600
- Minimum Order Quantity: 1
- Price: Negotiable
- Packaging Details: Plywood Cases
- Delivery Time: 15-60 Days
- Payment Terms: L/C, T/T
- Supply Ability: Based On Order



Product Specification

- Size: NPS 1/2"~20"
- Pressure Rating: Class 150~600
- Material: WCB, LCB, CF8, CF8M, CF3, CF3M, A890, MONEL, etc
- Design Standard: API 608, API 6D, BS 5351, ASME B16.34
- Face To Face: ASME B16.10, API 6D, BSEN 558
- End Connection: ASME B16.5, BSEN 1092
- Highlight: **trunnion type ball valve**

for more products please visit us on watercontrol-valve.com

Product Description

V type ball valve, 1/2"-20"CL150-600, good V notch, light weight

Surface Treatment

We offer the following processes to choose:

1. Mechanical Polishing (MP) to improve brightness (gloss, matte)
2. Acid Cleaning for Anti-corrosion
3. Electrolysis Polish (EP) to improve surface smoothness
4. Custom Process: Bright Annealing treatment eliminate stresses to improve toughness

Forming Machine Process

1. CNC Lathe Processing
2. High precision CNC machining center processing
3. General lathe processing
4. The machine punch the product parts
5. Cold Forming Molding
6. Welding Assembly

Our V-Ball, V-Port and V-Notch ball valves are made in CNC center. The V-ball, V "notch" is an exclusive design that allows precise flow with the ability to modulate and control the flow with 30°, 60°, or 90° degree V "notches". The V-Ball valve is a low maintenance valve with a tight bubble shut off feature. All valves have high manageability with the ability to work in high temperature (up to 1000°F) and in pressures as high as 500PSI (liquids) and 150PSI in steam. V-Ball valves are low cost comparable to valves of similar pressure drops and Cv's with low flow control (as low as 0.07). Our V-Ball valves can come in manual configuration or actuated for automated processing and control. These valves are available in ANSI flanged, NTP (threaded) and socket weld.

V type ball valves are an ideal solution to control flow through a pipe. V-Ball valves are a great solution to modulate flow and can be actuated. This series of V-Balls are made from 316 stainless steel and are configurable in almost any industry. These valves are both lighter in weight and more durable than standard valves sold overseas.

Sizes:

DN 25~250mm NPS 1"-10" (wafer type)

DN 25~500mm NPS 1"-20" (flange type)

Seat Material:

Resilient: PTFE/RPTFE/PEEK/DEVILON/NYLON

Metal: Tungsten Carbide/Satellite/Ni60

Pressure Rating:

PN 10/16/25/40/63

ANSI 150/300/600

Actuator :

Handle/Worm Gear

Pneumatic/Electric

Face to Face:

Wafer Type

ISA S75.04, IEC/DIN 534-3-2 (Flange Type)

Flange End:

GB/T 9113.1, JB/T 79.1, HG 20592,

ASME B 16.34, ISO 7005

(other connections on request)

Certificate:

API, GOST, CE, ISO9001, TS

Application:

Pulp & Paper/ Petrochemical /

Printing & Dying /Pharmacy/ Beverage & Food

The Wafer V Ball Valve is a quarter-turn control valve. Wafer V Ball Valve core is designed with a special V shape notch. This consequently contributes to strong shear force and precise flow control. Thus, Hiton's Wafer V Ball Valve is especially suitable for medium which contains fiber or solid particles.

Body

Integral body design ensures smooth flow, easy assembly and smaller shell leakage possibility.

Both wafer and flange connection are available.

Core

Specially designed V-notch ball provides strong cutting stress and tight sealing.

Hard chromium, nitriding, and HCOF treatments are all available for the ball surface treatment, improving hardness, abrasion resistance, fatigue resistance, corrosion resistance and performance under high temperature.

Well ground notched ball surface ensures small operating torque and tight seal, especially for metal seated segment valve.

Seat

Metal, RTFE or Devlon are available for seat options.

For valve rated under class 150, retainer is casted on valve body to eliminate any possible space between seat ring and body for residue

accumulation. Consequently, this ensures perfect seal.

Stem

The stem is finely ground to match the actuator excellently, which prevents rocking motion and potential failure of the segmented valve. Close-fit spline or pin-key are available for stem-core connection to provide reliable transmission without motion lost or dead band.

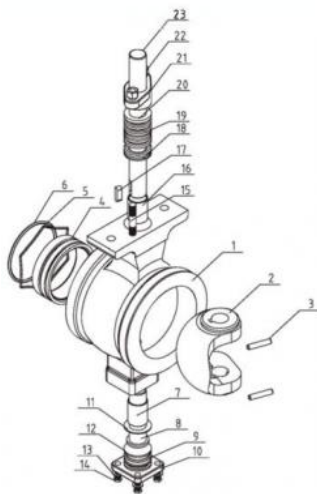

N.O	Part name	Quantity	Material		
1	Body	1	WCB	CF8	CF8M
2	valve core	1	CF8+hard chromium	CF8+hard chromium	CF8M+hard chromium
3	parallel pin	2	304	304	316
4	Seat	1	304+hard alloy overlaid	304+hard alloy overlaid	316
5	Spring	1	316	316	316
6	O-ring	1	Viton	Viton	Viton
7	Self-lubricated bearing		304+PTFE	304+PTFE	316+PTFE
8	Lower stem	1	20Cr13	304	316
9	O-ring	1	Viton	Viton	Viton
10	Lower cover	1	WCB	CF8	CF8M
11	Washer	1	PTFE	PTFE	PTFE
12	Adjusted gasket	1	PTFE	PTFE	PTFE
13	Flat gasket	4	Q235	304	304
14	Screw	4	25	304	304
15	Bolt	2	25	304	304
16	Self-lubricated bearing	1	304+PTFE	304+PTFE	316+PTFE
17	Key	1	20Cr13	304	316
18	Lower stem packing	1	PTFE	PTFE	PTFE
19	Middle stem packing	1 suit	PTFE	PTFE	PTFE
20	Upper stem packing	1	PTFE	PTFE	PTFE
21	Packing gland	1	WCB	CF8	CF8M
22	Nut	2	35	304	304
23	Upper stem	1	20Cr13	304	316

Body Option	Ball Option	Seat Option	Actuation
WCB	304+HCr/Nitriding/STL/ WC/ENP	PTFE	Handle
CF8		RPTFE	Worm Gear
CF8M	316+HCr/Nitriding/STL/ WC/ENP	PEEK	Pneumatic
CF3		DELVON	Electric
CF3M		NYLON	/



Beijing Silk Road Enterprise Management Services Co.,LTD



17733330123



miclecleanmo@gmail.com



watercontrol-valve.com

18-2 JinFu East Rd. Ulks Village. Futian New district. Shenzhen. China.