



## High Grade Ductile Iron Gate Valve Soft Seated For Water Supply / Sewage System

### Our Product Introduction

for more products please visit us on [watercontrol-valve.com](http://watercontrol-valve.com)

#### Basic Information

- Place of Origin: China
- Brand Name: OEM
- Certification: ISO9001, EN1074-2
- Model Number: RBHX, GBCX, GBHX
- Minimum Order Quantity: 1
- Price: Negotiable
- Packaging Details: Plywood Cases
- Delivery Time: 15-60 Days
- Payment Terms: L/C, T/T
- Supply Ability: Based On Order



#### Product Specification

- Standard: BS5163, ISO9001
- Color: Blue , Red EY300
- Rubber Material: EPDM
- O-ring: NBR
- Valve Material: Ductile Iron
- Powder: WRAS Approved Blue
- Highlight: resilient seated gate valve



#### More Images



## Product Description

### Flange Water High Grade Ductile Iron Gate Valve Soft Seated Drinking Water Approved

#### Forming Machine Process

1. CNC Lathe Processing
2. High precision CNC machining center processing
3. General lathe processing
4. The machine punch the product parts
5. Cold Forming Molding
6. Welding Assembly

AFC's Resilient seated gate valve is a soft seal wedge which is fully encapsulated with rubber. The valve is designed with new technology for light operating, no clogging and no corrosion, good resilient memory & long service life. It can be used extensively in all kinds of water supply & sewage, fire-fighting and function as a shut-off or regulating valve.

Flanged ends acc. to EN 1092-2.

The valve can be operated via handwheel, extension spindle, or electric actuators(on request).

#### Approval:

1. WRAS
2. EN1074-2
3. ISO 9001

#### Production Quality Control

IQC	Check call incoming parts
IPQC	Check the production process is qualified
FQC	All valves are pressure tested
OQC	Check the valve ourlook and packing

#### Production Process:

1. Shot Blasting
2. Fusion Bonded Epoxy Coating
3. Assembling
4. 100% tested with shell test and seat test for both side.

#### Application:

Size	DN50-DN600
Working Temperature	- 10 C- 80 C
Flange	PN10/16
Flow Media	Water, Sewage Water
Face to Face	EN558-1

#### Material:

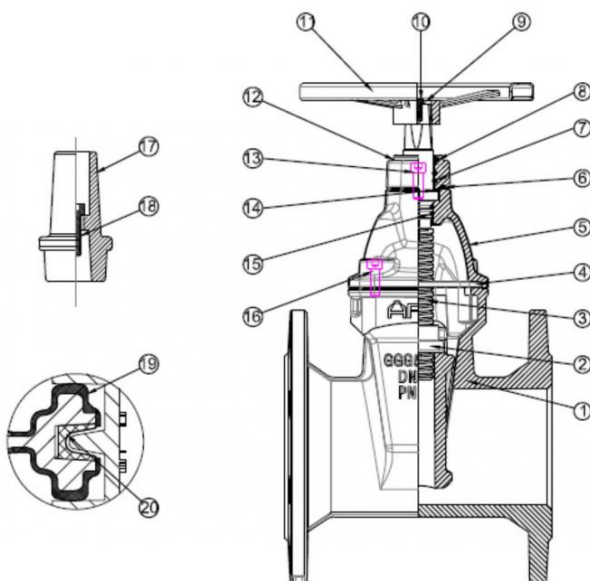

No.	Part Name	Material	Standard
1	Body	Ductile Iron	EN GJS 500-7
2	Wedge Nut	Bronze	CA103
3	Stem	Stainless Steel	AISI431
4	Gasket	Rubber	EPDM
5	Bonnet	Ductile Iron	EN GJS 500-7
6	O-ring	Rubber	NBR
7	O-ring	Rubber	NBR
8	Dust Wlper	Rubber	NBR
9	Washer	Stainless Steel	AISI304
10	Hex Bolt	Stainless Steel	AISI304
11	Hand Wheel	Carbon Steel	Commercial
12	Gland	Ductile Iron	EN GJS 500-7
13	In Hex Bolt	Carbon Steel	Commercial
14	Bushlng	Brass	CZ122
15	O-ring	Rubber	NBR
16	In Hex Bolt	Carbon Steel	Commercial
17	Cap	Ductile Iron	EN GJS 500-7
18	In Hex Bolt	Carbon Steel	Commercial
19	Wedge	Ductile Iron+Vulcanized Rubber	EN GJS 500-7+EPDM
20	Gulde	Plastlc	Nylon 66



**Beijing Silk Road Enterprise Management Services Co.,LTD**



17733330123



miclecleanmo@gmail.com



watercontrol-valve.com

18-2 JinFu East Rd. Ulks Village. Futian New district. Shenzhen. China.