



Water Hammer Control Non Slam Check Valve For Cooling / HVAC System

Our Product Introduction

for more products please visit us on watercontrol-valve.com

Basic Information

- Place of Origin: China
- Brand Name: OEM
- Certification: WRAS, NSF61/372
- Model Number: NSCV
- Minimum Order Quantity: 1
- Price: Negotiable
- Packaging Details: Plywood Cases
- Delivery Time: 15-60 Days
- Payment Terms: L/C, T/T
- Supply Ability: Based On Order



Product Specification

- Material: Ductile Iron GJS500-7
- Standard: EN1074-3, EN12233
- Function: Anti Water Hammer
- Coating: EPOXY
- Color: Blue
- Head Loss: Low
- Highlight: **water pressure valve**



More Images



Product Description

Water Hammer Control Non Slam Check Valve EPOXY Coated Quick Close Ductile iron

How do we control the quality of machining

1. High-precision CNC lathe processing parts.
2. Advanced Milling Machines
3. UT Inspection to ensure welding quality
4. Weld Polishing
5. 100% Appearance & Size Inspection online (thickness, roundness, etc.)
6. Size & Appearance Shaping

Features:

- High strength ductile iron body used for durability and less weight.
- Advanced dynamic design of single body with diffuser provides streamline flow and assures lower head loss.
- One of the lowest head loss check valve, big save in pumping power cost, valve disc with shorter stroker and spring reverse faster than most of check valve.
- Coated with powder epoxy both inside & outside for corrosion resistance.
- Bronze bushing reduce wearing problem during operation.
- Hydrodynamic design with spring ensures non slamming and water hammerless.
- Stainless steel spring hidden in the diffuser under protection while valve in operation.
- Disc will positively close before reverse flow, and maximize the closing speed up to 0.2 Sec.
- Installation can be vertical/horizontal/inclined.
- Comply with EN 558-1, ISO 5752 and EN 1092-2, ISO 7005-2 flange dimension.

Technical Data:

Size	DN50-DN600
Working Temperature	- 10 C- 80 C
Flange	AISI B16.1 Or PN16
Flow Media	Clean Water

Description

NSCV- Non Slam Check Valve is used as protection against reverse flow when power failure in areas where noise pollution or water hammering is a critical issue. It can provide not only quiet performance but also low head loss.

Service Fields:

Mainly used for clean water, precleaned sewage water, Fire-fighting, Irrigation, Cooling and HVAC System.

Dimension:

DN50 - DN350

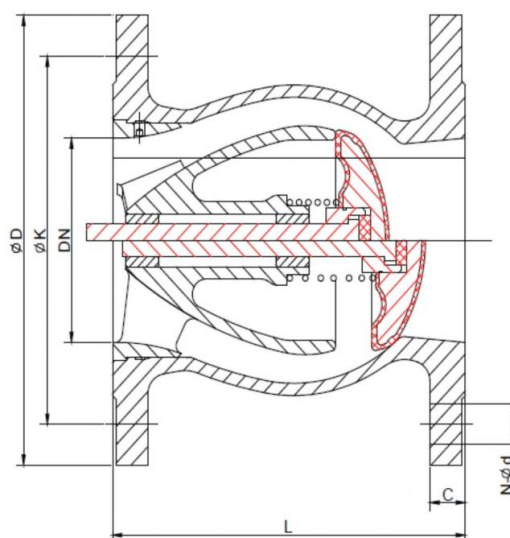

Dimension:

Unit: mm

DN	Model No	L (F/F)	ØD			ØK			n-Ød			C	
			PN10	PN16	PN25	PN10	PN16	PN25	PN10	PN16	PN25	PN10/16	PN25
50	NSCV-0050	150		165			125			4-Ø19		19	
65	NSCV-0065	170		185			145			4-Ø19	8-Ø19	19	
80	NSCV-0080	180		200			160			8-Ø19	8-Ø19	19	
100	NSCV-0100	190	220	235		180	190			8-Ø19	8-Ø23	19	
125	NSCV-0125	200	250	270		210	220			8-Ø23	8-Ø28	19	23.5
150	NSCV-0150	210	285	300		240	250			8-Ø23	8-Ø28	19	26
200	NSCV-0200	230	340	360		295	310		8-Ø23	12-Ø23	12-Ø31	20	30
250	NSCV-0250	250	395	405	425	350	355	370	12-Ø23	12-Ø28	12-Ø34	22	34.5
300	NSCV-0300	270	445	460	485	400	410	430	12-Ø23	12-Ø28	16-Ø34	24.5	39.5
350	NSCV-0350	290	505	520	555	460	470	490	16-Ø23	16-Ø28	16-Ø37	24.5	44

DN400 - DN600

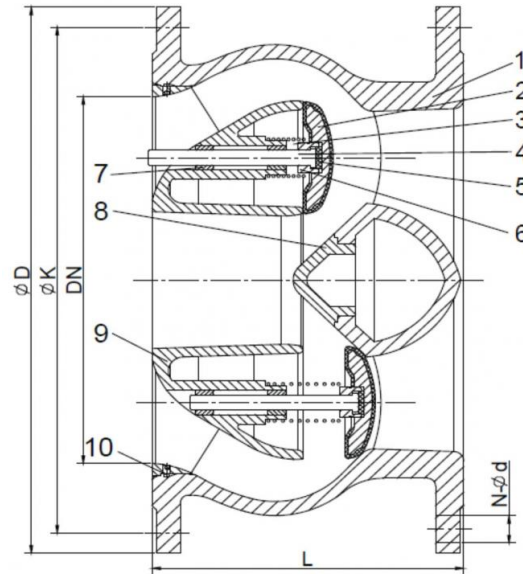

Dimension:

Unit: mm

DN	Model No.	L (F/F)	ØD			ØK			n-Ød			C	
			PN10	PN16	PN25	PN10	PN16	PN25	PN10	PN16	PN25	PN10/16	PN25
400	NSCV-0400	310	565	580	620	515	525	550	16-Ø28	16-Ø31	16-Ø41	24.5	48
450	NSCV-0450	330	615	640	670	565	585	600	20-Ø28	20-Ø31	20-Ø41	25.5	49
500	NSCV-0500	350	670	715	730	620	650	660	20-Ø28	20-Ø34	20-Ø44	26.5	52
600	NSCV-0600	390	780	840	845	725	770	770	20-Ø31	20-Ø37	20-Ø50	30	58

Materials:

DN50-DN350

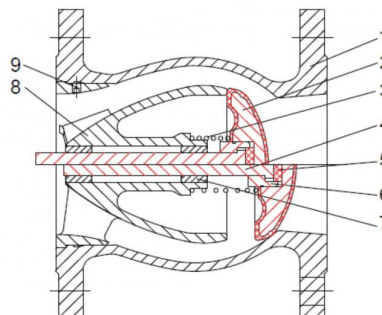

Parts List

No.	Part Name	Material	Standard
1	Body	Ductile Iron	GJS 500-7
2	Disc	Ductile iron+rubber	GJS 500-7+EPDM/NBR
3	Spring	Stainless Steel	AISI 304/ 316
4	Stem	Stainless Steel	AISI 420/ 304/ 316
5	Washer	Plastic/ Rubber	Nylon/ EPDM
6	Nut	Stainless Steel	AISI 420/ 304
7	Bushing	Bronze	C61900
8	Diffuser	Ductile Iron	GJS 500-7
9	Set Screw	Stainless Steel	AISI 304

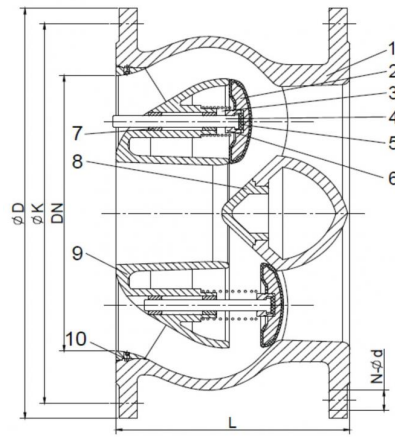

No.	Part Name	Material	Standard
1	Body	Ductile Iron	GJS 500-7
2	Disc	Ductile iron+rubber	GJS 500-7+EPDM
3	Spring	Stainless Steel	AISI 304/ 316
4	Stem	Stainless Steel	AISI 304
5	Washer	Plastic	Nylon
6	Nut	Stainless Steel	AISI 304
7	Bushing	Bronze	C61900
8	Plug	Ductile Iron	GJS 500-7
9	Diffuser	Ductile Iron	GJS 500-7
10	Set Screw	Stainless Steel	AISI 304



Beijing Silk Road Enterprise Management Services Co.,LTD



17733330123



miclecleanmo@gmail.com



watercontrol-valve.com

18-2 JinFu East Rd. Ulks Village. Futian New district. Shenzhen. China.